

XP SERIES-ULTRA HIGH RATE

XP12-100 (12V100W)

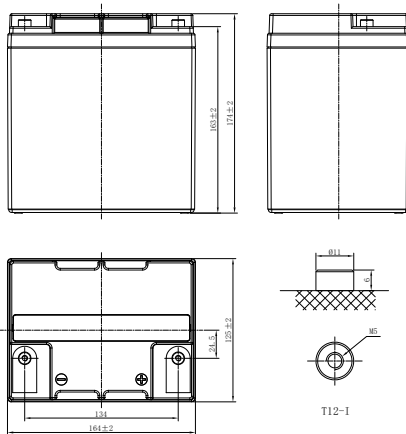

CHARACTERISTICS

Item	Specifications	
Rated Voltage	12V	
Nominal Rate (25°C)	W_{15} , 1.67V/cell	100W/cell
Nominal Capacity (25°C)	C_{20} , 1.80V/cell	27.6Ah
Dimension	Length	164mm (6.46inches)
	Width	125mm (4.92inches)
	Container Height	174mm (6.85inches)
	Total Height	174mm (6.85inches)
Approx Weight	8.40kg (18.5lbs)	
Terminal	T12-I/T12(M5)	
Container Material	ABS (UL94 HB or V-0 optional)	
Short-circuit current	690A	
Internal Resistance (25°C)	Approx 8.5 mΩ (Fully charged)	
Operating Temp. Range	Discharge	-15~50°C (5~122°F)
	Charge	-20~40°C (-4~104°F)
	Storage	-15~40°C (5~104°F)
Nominal Operating Temp. Range	25±3°C (77±5°F)	
Max.Charging Current (25°C)	0.25C	
Charge voltage (25°C)	Standby Use	Equalization Use
	2.25-2.30V/cell	2.30-2.40V/cell
Temp. Coefficient	-3mV/cell/°C	
	40°C (104°F)	106%
Effect of temp. to Capacity	25°C (77°F)	100%
	0°C (32°F)	86%
	Self Discharge	≤3% per month at 25°C (77°F)

DISCHARGE TABLE

Constant Current Discharge (Amperes) at 25°C (77°F)																
F.V/Time	5min	10min	15min	20min	30min	45min	1h	2h	3h	4h	5h	6h	8h	10h	20h	
1.85V/cell	86.6	59.3	46.5	37.8	27.8	20.3	16.7	9.58	6.92	5.51	4.69	4.02	3.16	2.59	1.37	
1.80V/cell	93.2	62.8	48.7	39.3	28.7	20.9	17.1	9.76	7.03	5.59	4.76	4.08	3.21	2.62	1.38	
1.75V/cell	98.2	65.3	50.4	40.4	29.4	21.3	17.4	9.94	7.14	5.67	4.82	4.13	3.25	2.65	1.40	
1.70V/cell	102.8	68.0	52.0	41.6	30.2	21.8	17.7	10.1	7.25	5.75	4.89	4.18	3.28	2.68	1.41	
1.67V/cell	106.4	69.9	53.3	42.4	30.7	22.2	18.0	10.2	7.32	5.80	4.93	4.21	3.31	2.69	1.42	
1.60V/cell	112.8	72.8	55.2	43.7	31.5	22.7	18.4	10.4	7.45	5.90	5.01	4.27	3.35	2.73	1.44	

Constant Power Discharge (Watts/cell) at 25°C (77°F)																
F.V/Time	5min	10min	15min	20min	30min	45min	1h	2h	3h	4h	5h	6h	8h	10h	20h	
1.85V/cell	163.9	112.8	89.0	72.8	53.8	39.4	32.4	18.8	13.6	10.9	9.26	7.95	6.27	5.14	2.74	
1.80V/cell	174.6	118.7	92.8	75.3	55.2	40.4	33.1	19.1	13.8	11.0	9.38	8.06	6.36	5.21	2.77	
1.75V/cell	181.9	122.6	95.3	77.0	56.4	41.1	33.6	19.4	14.0	11.1	9.49	8.14	6.42	5.25	2.80	
1.70V/cell	188.6	126.7	97.9	78.8	57.5	41.8	34.1	19.6	14.2	11.3	9.61	8.23	6.48	5.31	2.82	
1.67V/cell	193.6	129.5	100.0	80.2	58.4	42.4	34.6	19.8	14.3	11.4	9.68	8.30	6.53	5.34	2.84	
1.60V/cell	201.4	133.3	102.7	82.2	59.7	43.2	35.2	20.1	14.5	11.5	9.81	8.40	6.62	5.40	2.88	

XP SERIES-ULTRA HIGH RATE

XP12-100 (12V100W)



APPLICATIONS

- UPS
- Hospitals and Testing Laboratories
- Emergency Power Supply
- Electric starting
- Telecommunications
- Data Centers

GENERAL FEATURES

- 12 years design life (25°C)
- Excellent high current performance - optimised for short discharge time
- Advanced AGM technology for superior high-rate power
- Long Life Alloy - minimizing grid growth, reducing gassing and extending battery life
- Epoxy-sealed posts eliminate leaks
- Optimal energy density - saves floor space

STANDARDS

- Compliance with IEC 60896 standards
- Classified as "Long Life" according to Eurobat
- CE,UL Approved
- Manufactured in Leoch@IATF 16949, ISO 45001,ISO 9001 and ISO 14001 certified production facilities

Discharge Characteristics

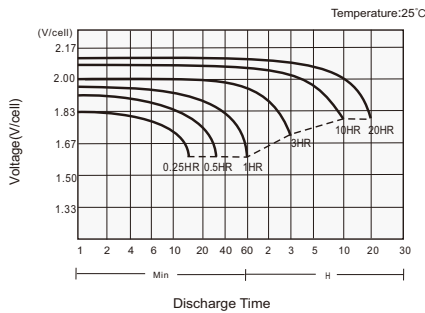

Charging Characteristics

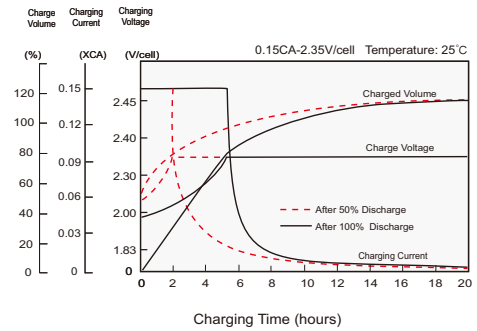

Effects of Temperature on Capacity

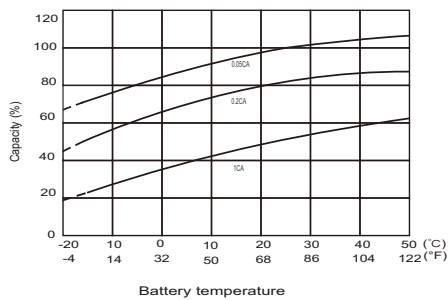

Self Discharge Characteristics

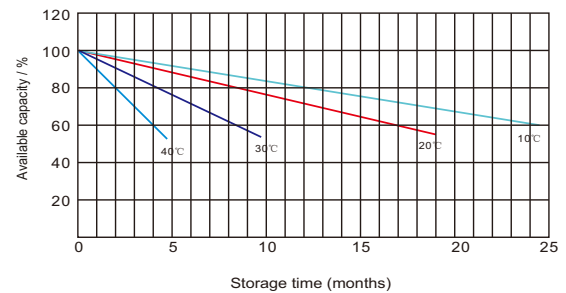

Leoch International Technology Ltd.
www.leoch.com

Leoch Batteries Pte Ltd
www.leoch.sg

Leoch Battery Corporation
www.leochamericas.com

Leoch Europe S.A.
www.leoch.eu

Data above is recommended and the picture is only for battery effect display, Leoch reserve the final right of explanation.
 © LEOCH. All rights reserved. Trademarks and logos are the property of LEOCH and its affiliates unless otherwise noted. Subject to revisions without prior notice. E&OE.

Publication No.:LB-XP12-100-PD-EN-V2.0-20231229